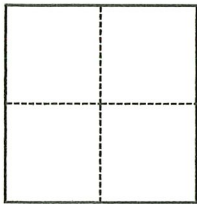

CORNER RECORD

Agency Index CR22-007Document Number 038-381-18 (ADJ)City of Tiburon County of Marin, CaliforniaBrief Legal Description Paradise Drive centerline monument**CORNER TYPE****COORDINATES (Optional)**

- Government Corner Control
 Meander Property
 Rancho Other

Date of Survey May 3, 2021

N. _____ E. _____

Elevation _____

Units Metric U.S. Survey Foot

Horizontal Datum _____

Zone _____ Epoch Date _____

Vertical Datum _____

 Complies with Public Resources Code §§8801-8819 Complies with Public Resources Code §§8890-8902PLS Act Ref.: 8765(d) 8771 8773 Other:Corner/Monument: Left as found Established Rebuilt Pre-Construction Found and tagged Reestablished Referenced Post-Construction

Narrative of corner identified and monument as found, set, reset, replaced, or removed:

 See sheet #2 for description(s):

Station 78: Found monument at angle point in the centerline of Paradise Drive, as surveyed in 1938 by J.C.Oglesby, Field Book 255-18, on file at Kent Library, Marin County. Monument well set by county.

Station 86: Found monument at angle point in the centerline of Paradise Drive, as surveyed in 1938 by J.C.Oglesby, Field Book 255-19, on file at Kent Library, Marin County. Monument well set by county.

SURVEYOR'S STATEMENT

This Corner Record was prepared by me or under my direction in conformance with

the Professional Land Surveyors' Act on April 19, 2022Signed Robert J. Reese P.L.S. or R.C.E. No. 6208**COUNTY SURVEYOR'S STATEMENT**This Corner Record was received 4/25/2022and examined and filed 5/2/2022Signed T. K. Park P.L.S. or R.C.E. No. 8176Title COUNTY SURVEYOR

County Surveyor's Comment



Apr 19, 2022 C:\1 JOBS\2014-crandall\survey8-certcorr&correc\2014-corner-record.pro

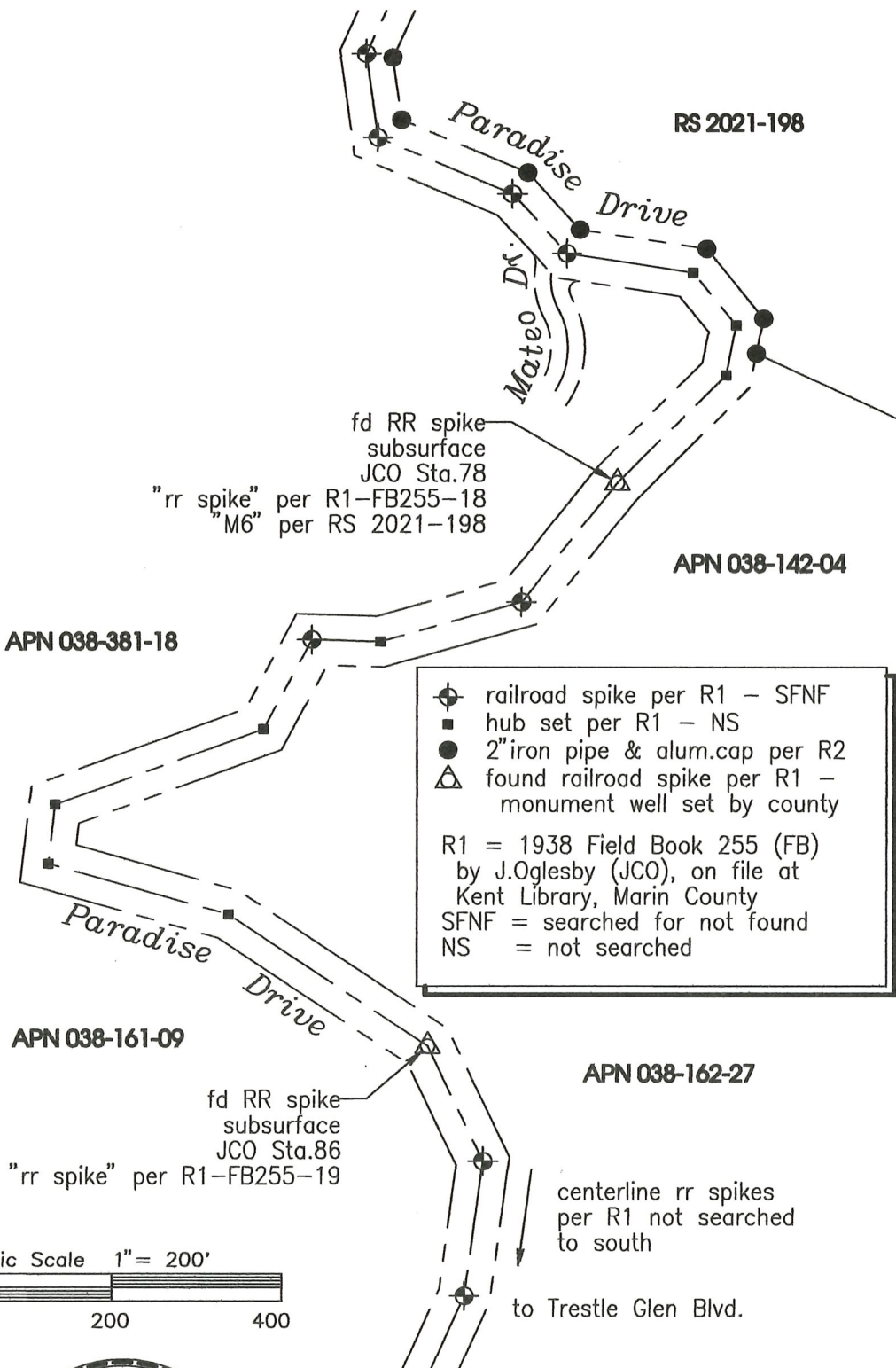

- ⊕ railroad spike per R1 - SFNF
 - hub set per R1 - NS
 - 2" iron pipe & alum.cap per R2
 - △ found railroad spike per R1 - monument well set by county
- R1 = 1938 Field Book 255 (FB)
by J.Oglesby (JCO), on file at
Kent Library, Marin County
SFNF = searched for not found
NS = not searched

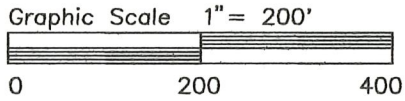

REESE
Water 
& Land
SURVEYING SERVICES
900-B Los Osos Valley Road
Los Osos, CA 93402-3206
805.439.2741